

## # BC SERIES

## 3-PIECE FULL PORT BALL VALVE

STAINLESS STEEL

SUS316 (EN10213-4 1.4408) (ASTM-A351-CF8M)

SUS304 (EN10213-4 1.4308) (ASTM-A351-CF8)

FEATURES:

Investment casting body

Cap materials available in 316 stainless steel

The platform is fixed

100% factory tested

SWG. END. BUTT WELD END.



SPECIFICATION								
Seat Material	Temp. Range	Pressure	Leak Rates					
			Inboard			Across Seat		
PTFE	-10 ~ 80°C	50kgf/cm <sup>2</sup>	$\leq 1.0 \times 10^{-6}$			$\leq 1.0 \times 10^{-6}$		
TFM1600	-10~120°C	165kgf/cm <sup>2</sup>	atm.cc/sec He			atm.cc/sec He		
SWG . END								
Model	Size	d	L	H	H1	W	W1	
4BC-SW-SS	1/4"	6.35	64.5	38.4	28.4	45.5	15.93	
6BC-SW-SS	3/8"	9.52	72	42	31	59.3	20	
8BC-SW-SS	1/2"	12.7	82	47	33.1	67	22	
12BC-SW-SS	3/4"	19.05	89	49.75	32.5	67	22	
BUTT WELD END								
Model	Size	d	L	H	H1	W	W1	
4BC-BW-SS	1/4"	6.35	87	38.4	28.4	45.5	15.93	
6BCBW-SS	3/8"	9.52	91	42	31	59.3	20	
8BC-BW-SS	1/2"	12.7	96.5	47	33.1	67	22	
12BC-BW-SS	3/4"	19.05	114	49.75	32.5	67	22	
STRUCTURE								
Parts	Material							
BODY	SUS316							
CAP	SUS316							
BALL	SUS316							
BALL SEAT	PTFE							
STEM	SUS316							
HANDLE	POM							
RANEL NUT	SUS316							

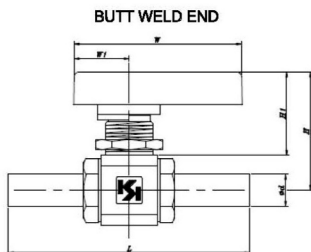
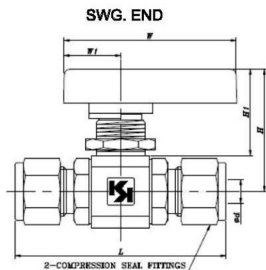

## # NW SERIES

## 3-PIECE FULL PORT BALL VALVE

STAINLESS STEEL

SUS316 (EN10213-4 1.4408) (ASTM-A351-CF8M)

SUS304 (EN10213-4 1.4308) (ASTM-A351-CF8)

FEATURES:

Blow-out proof stem/Full port

Investment casting body and cap

Direct Mounting Pad for ISO Standard 5211

CLAMP END

100% factory tested

## SPECIFICATION

Seat Material	Temp. Range	Pressure	Leak Rates	
			Inboard	Across Seat
PTFE	-10 ~ 80°C	10kgf/cm <sup>2</sup>	$\leq 1.0 \times 10^{-6}$ atm.cc/sec He	$\leq 1.0 \times 10^{-6}$ atm.cc/sec He

## BUTT WELD.END

Model	Size	W	L	H	H1	D
NW16	1/2"	112	92	38	9.8	30
NW25	3/4"	138	112.2	41.7	11.5	40
NW40	1-1/2"	205	127.5	59.5	16	55
NW50	2"	205	178	67	16	75

## STRUCTURE

Parts	Material
BODY	SUS 316
CAP	SUS 316
BALL	SUS 316
BALL SEAT	PTFE
JOINT GASKET	PTFE
STEM	SUS 316
THRUST WASHER	PTFE
STEM PACKING	PTFE
HIGH WASHER	SUS 304
BELLEVILLE WASHER	SUS 304
STEM NUT	SUS 304
O-RING	VITON
BOLT	SUS 304
SPRING WASHER	SUS 304
HEX NUT	SUS 304
STOPPER	SUS 304
HANDLE	SUS 304
PLASTIC COVER	PLASTIC
STOPPER PIN	SUS 304
LOCK WASHER	SUS 304

CLAMP END

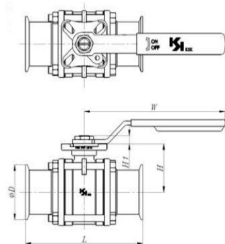

CLAMP END+OPP(SWG)

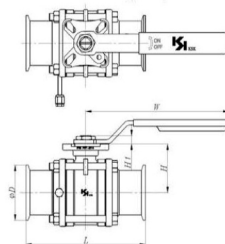

CLAMP END+OPP(SWG)

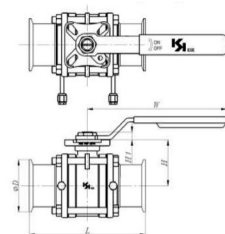

## # V2FH SERIES

## 2-PIECE FULL PORT BALL VALVE

JIS10K , JIS20K

STAINLESS STEEL

SUS 316(EN10213-4 1.4408)(ASTM-A351-CF8M)

SUS 304(EN10213-4 1.4308)(ASTM-A351-CF8)

FEATURES:

Flang:JIS 10K B2212 JIS 20K B2214

Face to face:DIN3202 F1/F4/F5

Anti-static device,fire safe design

Blow-out proof stem , lever operated

Direct Mountig Pad ISO 5211

FLANGED END

100% factory tested

FLANGED END

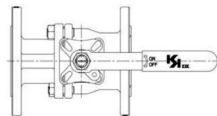

SPECIFICATION				
Seat Material	Temp. Range	Pressure	Leak Rates	
			Inboard	Across Seat
PTFE	-10 ~ 80°C	10kgf/cm <sup>2</sup>	≤ 1.0×10 <sup>-1</sup> atm.cc/sec He	≤ 1.0×10 <sup>-5</sup> atm.cc/sec He

## FLANGED END (JIS 10K)

Model	Size	ΦD	ΦPod	L	H	H1	W
15A	1/2"	95	70	110	46.5	56	110
20A	3/4"	100	75	120	51.5	61	110
25A	1"	125	90	130	57.5	67	136
32A	1-1/4"	135	100	140	71.5	87	175
40A	1-1/2"	140	105	165	76.5	92	203
50A	2"	155	120	180	83.5	99	203
65A	2-1/2"	175	140	190	118.5	137	277.5
80A	3"	185	150	200	129.5	148	277.5
100A	4"	210	175	230	145	163.5	377.5
125A	5"	250	210	300	158.5	202.1	500
150A	6"	280	240	340	170	213.6	600

## FLANGED END (JIS 10K)

Model	Size	ΦD	ΦPod	L	H	H1	W
15A	1/2"	95	70	140	47.5	56	110
20A	3/4"	100	75	152	58.5	61	110
25A	1"	125	90	165	62.5	67	136
40A	1-1/2"	140	105	190	78	92	203
50A	2"	155	120	216	83.5	99	203
65A	2-1/2"	175	140	241	118.5	137	277.5
80A	3"	200	160	283	129.5	148	277.5
100A	4"	225	185	305	145	163.5	377.5

## STRUCTURE

Parts	Material
BODY	CF8M
CAP	CF8M
BALL	SUS316
BALL SEAT	PTFE
JOINT GASKET	PTFE
STEM	SUS316
THRUST WASHER	PTFE(Graphite)
O-RING	VITON
STEM PACKING	PTFE
STEM RING	SUS304
BELLEVILLE WASHER	SUS304
STEM NUT	SUS304
STOPPER	SUS304
SPRING WASHER	SUS304
HANDLE	SUS304
PLASTIC COVER	PLASIC
NUT1	SUS304
STUD BOLT1	SUS304
NUT2	SUS304
STUD BOLT2	SUS304
LOCK WASHER	SUS304

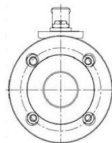
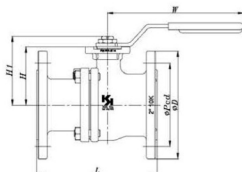

## # V2FH SERIES

## 2-PIECE FULL PORT BALL VALVE

JIS10K

STAINLESS STEEL

SUS 316(EN10213-4 1.4408)(ASTM-A351-CF8M)

SUS 304(EN10213-4 1.4308)(ASTM-A351-CF8)

FEATURES:

Flang:JIS 10K B2212

Face to face:DIN3202 F1/F4/F5

Anti-static device,fire safe design

Blow-out proof stem , lever operated

Direct Mountig Pad ISO 5211

FLANGED END

100% factory tested

SPECIFICATION									
Seat Material	Temp.Range	Pressure	Leak Rates						
			Inboard	Across Seat					
PTFE	-10 ~ 80°C	10kgf/cm <sup>2</sup>	$\leq 1.0 \times 10^{-6}$	$\leq 1.0 \times 10^{-6}$					
					atm.cc/sec He				
FLANGED END (JIS 10K)									
Model	Size	ΦD	ΦPcd	L	H	L1	X	X1	
15A	1/2"	95	70	110	46.5	109	176	56	
20A	3/4"	100	75	120	51.5	109	178	56	
25A	1"	125	90	130	57.5	131	195	66	
32A	1-1/4"	135	100	140	71.5	165	214	86	
40A	1-1/2"	140	105	165	76.5	165	256	86	
50A	2"	155	120	180	83.5	165	259	86	
65A	2-1/2"	175	140	190	118.5	200	306	104	
80A	3"	185	150	200	129.5	200	309	104	
100A	4"	210	175	230	145	249	347	120	
125A	5"	250	210	300	158.5	292	380	150	
150A	6"	280	240	340	170	328	449	180	

## STRUCTURE

Parts	Material
BODY	CF8M
CAP	CF8M
BALL	SUS316
BALL SEAT	PTFE
JOINT GASKET	PTFE
STEM	SUS316
THRUST WASHER	PTFE(Graphite)
O-RING	VITON
STEM PACKING	PTFE
STEM RING	SUS304
BELLEVILLE WASHER	SUS304
STEM NUT	SUS304
STOPPER	SUS304
SPRING WASHER	SUS304
HANDLE	SUS304
PLASTIC COVER	PLASIC
NUT1	SUS304
STUD BOLT1	SUS304
NUT2	SUS304
STUD BOLT2	SUS304
LOCK WASHER	SUS304

FLANGED END

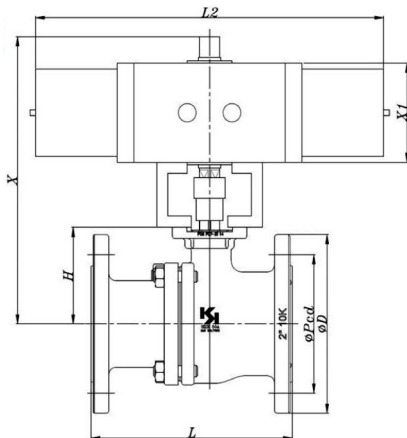

## # V2FH SERIES

## 2-PIECE FULL PORT BALL VALVE

JIS10K

STAINLESS STEEL

SUS 316(EN10213-4 1.4408)(ASTM-A351-CF8M)

SUS 304(EN10213-4 1.4308)(ASTM-A351-CF8)

FEATURES:

Flang:JIS 10K B2212

Face to face:DIN3202 F1/F4/F5

Anti-static device,fire safe design

Blow-out proof stem , lever operated

Direct Mountig Pad ISO 5211

FLANGED END

100% factory tested

SPECIFICATION									
Seat Material	Temp.Range	Pressure	Leak Rates						
			Inborad	Across Seat					
PTFE	-10 ~ 80°C	10kgf/cm <sup>2</sup>	≤ 1.0×10 <sup>6</sup> atm.cc/sec He		≤ 1.0×10 <sup>6</sup> atm.cc/sec He				
FLANGED END (JIS 10K)									
Model	Size	ΦD	ΦPcd	L	H	L1	X	X1	
15A	1/2"	95	70	110	46.5	109	176	56	
20A	3/4"	100	75	120	51.5	109	178	56	
25A	1"	125	90	130	57.5	131	195	66	
32A	1-1/4"	135	100	140	71.5	165	214	86	
40A	1-1/2"	140	105	165	76.5	165	256	86	
50A	2"	155	120	180	83.5	165	259	86	
65A	2-1/2"	175	140	190	118.5	200	306	104	
80A	3"	185	150	200	129.5	200	309	104	
100A	4"	210	175	230	145	249	347	120	
125A	5"	250	210	300	158.5	292	380	150	
150A	6"	280	240	340	170	328	449	180	

## STRUCTURE

Parts	Material
BODY	CF8M
CAP	CF8M
BALL	SUS316
BALL SEAT	PTFE
JOINT GASKET	PTFE
STEM	SUS316
THRUST WASHER	PTFE(Graphite)
O-RING	VITON
STEM PACKING	PTFE
STEM RING	SUS304
BELLEVILLE WASHER	SUS304
STEM NUT	SUS304
STOPPER	SUS304
SPRING WASHER	SUS304
HANDLE	SUS304
PLASTIC COVER	PLASIC
NUT1	SUS304
STUD BOLT1	SUS304
NUT2	SUS304
STUD BOLT2	SUS304
LOCK WASHER	SUS304

## FLANGED END

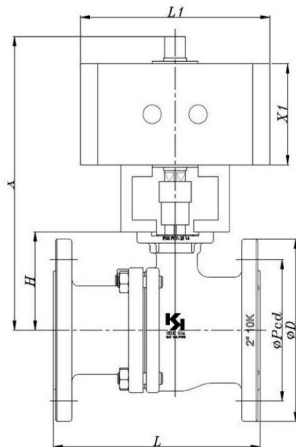

## # V2FH SERIES

## 2-PIECE FULL PORT BALL VALVE

JIS10K

STAINLESS STEEL

SUS 316(EN10213-4 1.4408)(ASTM-A351-CF8M)

SUS 304(EN10213-4 1.4308)(ASTM-A351-CF8)

FEATURES:

Flang:JIS 10K B2212

Face to face:DIN3202 F1/F4/F5

Anti-static device,fire safe design

Blow-out proof stem , lever operated

Direct Mountig Pad ISO 5211

FLANGED END

100% factory tested

SPECIFICATION						
Seat Material	Temp.Range	Pressure	Leak Rates		L	H
			Inborad	Across Seat		
PTFE	-10 ~ 80°C	10kgf/cm <sup>2</sup>	$\leq 1.0 \times 10^{-6}$ atm.cc/sec He	$\leq 1.0 \times 10^{-6}$ atm.cc/sec He		
FLANGED END (JIS 10K)						
Model	Size	$\phi D$	$\phi Pcd$	L	H	L1
125A	5"	250	210	300	158.5	335
150A	6"	280	240	340	170	355

FLANGED END

## STRUCTURE

Parts	Material
BODY	CF8M
CAP	CF8M
BALL	SUS316
BALL SEAT	PTFE
JOINT GASKET	PTFE
STEM	SUS316
THRUST WASHER	PTFE(Graphite)
O-RING	VITON
STEM PACKING	PTFE
STEM RING	SUS304
BELLEVILLE WASHER	SUS304
STEM NUT	SUS304
STOPPER	SUS304
SPRING WASHER	SUS304
HANDLE	SUS304
PLASTIC COVER	PLASIC
NUT1	SUS304
STUD BOLT1	SUS304
NUT2	SUS304
STUD BOLT2	SUS304
LOCK WASHER	SUS304

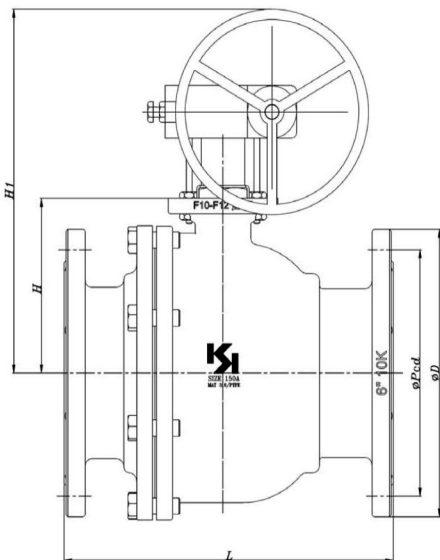

## # Purge port

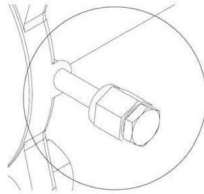
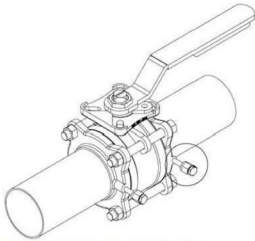

### Purge port 擴充示意圖

#### Purge port(OPP):SWG

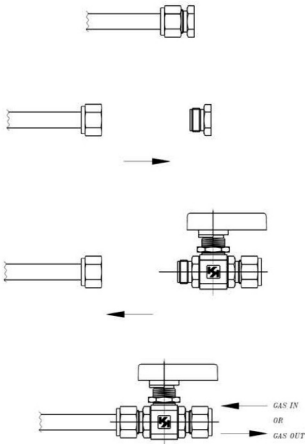

15A ~ 100A : 1/4" SWG  
125A ~ 250A : 1/2" SWG

#### Purge port(OPP):VCR

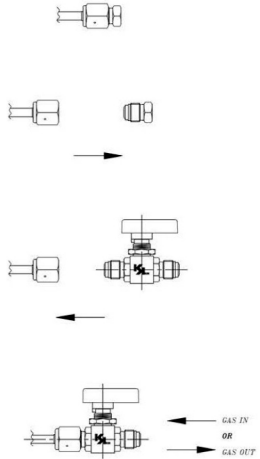

15A ~ 100A : 1/4" VCR  
125A ~ 250A : 1/2" VCR

## # V3NMH SERIES

## 3-PIECE FULL PORT BALL VALVE

STAINLESS STEEL

SUS 316(EN10213-4 1.4408)(ASTM-A351-CF8M)

SUS 304(EN10213-4 1.4308)(ASTM-A351-CF8)

FEATURES:

Blow-out proof stem /Full port

Investment casting body and cap

Direct Mounting Pad for ISO Standard 5211

BUTT WELD END

100% factory tested

SPECIFICATION						
Seat Material	Temp.Range	Pressure	Leak Rates			
			Inborad	Across Seat		
PTFE	-10 ~ 80°C	10kgf/cm <sup>2</sup>	$\leq 1.0 \times 10^{-6}$ atm.cc/sec He	$\leq 1.0 \times 10^{-6}$ atm.cc/sec He		
FLANGED END (JIS 10K)						
Model	Size	W	L	H	H1	D1
15A	1/2"	112	162	38	9.8	21.7
20A	3/4"	138	177	41.7	11.5	27.1
25A	1"	138	193	44.4	11.5	34
32A	1-1/4"	160	214	54	16	42.7
40A	1-1/2"	205	277	59.5	16	48.6
50A	2"	205	300	67	16	60.5
65A	2-1/2"	330	356	101.5	19	76.3
80A	3"	330	402	112.5	19	89.1
100A	4"	330	483.6	127	19	114.3
125A	5"	500	583	158.5	47	139.8
150A	6"	500	692	175	47	165.2
200A	8"	1000	880	210	47	216.3

STRUCTURE	
Parts	Material
BODY	SUS316
CAP	SUS316L
BALL	SUS316
BALL SEAT	PTFE
JOINT GASKET	PTFE
STEM	SUS316
THRUST WASHER	PTFE
STEM PACKING	PTFE
HIGH WASHER	SUS304
BELLEVILLE WASHER	SUS304
STEM NUT	SUS304
O-RING	VITON
BOLT	SUS304
SPRING WASHER	SUS304
HEX NUT	SUS304
STOPPER	SUS304
HANDLE	SUS304
PLASTIC COVER	PLASTIC
STOPPER PIN	SUS304
LOCK WASHER	SUS304

BUTT WELD END

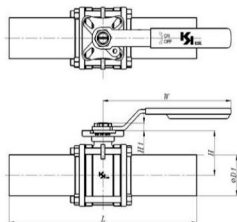

BUTT WELD END+OPP(SWG)

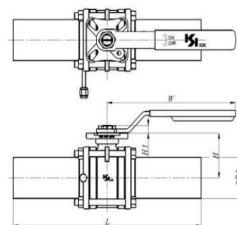

BUTT WELD END+IOPP(SWG)

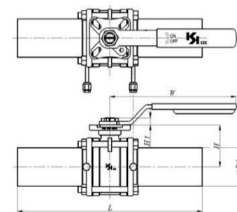



## # V3NMH SERIES

**3-PIECE FULL PORT BALL VALVE**

STAINLESS STEEL

SUS 316(EN10213-4 1.4408)(ASTM-A351-CF8M)

SUS 304(EN10213-4 1.4308)(ASTM-A351-CF8)

FEATURES:

Blow-out proof stem /Full port

Investment casting body and cap

Direct Mounting Pad for ISO Standard 5211

BUTT WELD END

100% factory tested

SPECIFICATION							
Seat Material	Temp. Range	Pressure	Leak Rates				
			Inboard	Across Seat			
PTFE	-10 ~ 80°C	10kgf/cm <sup>2</sup>	≤ 1.0×10 <sup>-6</sup> atm.cc/sec He				
			≤ 1.0×10 <sup>-6</sup> atm.cc/sec He				
FLANGED END (JIS 10K)							
Model	Size	L	L2	X1	X	H	D1
15A	1/2"	162	250	66	172	38	21.7
20A	3/4"	177	311	86	194	41.7	27.2
25A	1"	193	311	86	197	44.4	34
32A	1-1/4"	214	311	86	242	54	42.7
40A	1-1/2"	277	365	104	247	59.5	48.6
50A	2"	300	365	104	255	67	60.5
65A	2-1/2"	356	417	120	288	101.5	76.3
80A	3"	402	417	120	301	112.5	89.1
100A	4"	483.6	516	150	320	127	114.3

**STRUCTURE**

Parts	Material
BODY	SUS316
CAP	SUS316L
BALL	SUS316
BALL SEAT	PTFE
JOINT GASKET	PTFE
STEM	SUS316
THRUST WASHER	PTFE
STEM PACKING	PTFE
HIGH WASHER	SUS304
BELLEVILLE WASHER	SUS304
STEM NUT	SUS304
O-RING	VITON
BOLT	SUS304
SPRING WASHER	SUS304
HEX NUT	SUS304
STOPPER	SUS304
HANDLE	SUS304
PLASTIC COVER	PLASTIC
STOPPER PIN	SUS304
LOCK WASHER	SUS304

BUTT WELD END

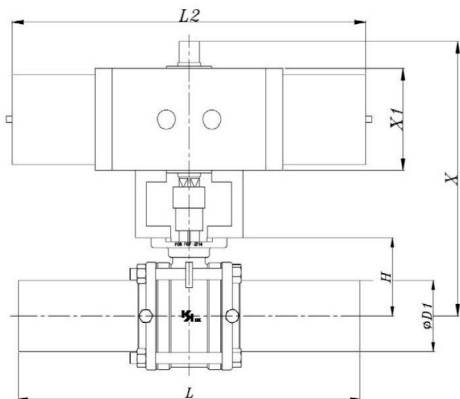

## # V3NMH SERIES

**3-PIECE FULL PORT BALL VALVE**

STAINLESS STEEL

SUS 316(EN10213-4 1.4408)(ASTM-A351-CF8M)

SUS 304(EN10213-4 1.4308)(ASTM-A351-CF8)

FEATURES:

Blow-out proof stem /Full port

Investment casting body and cap

Direct Mounting Pad for ISO Standard 5211

BUTT WELD END

100% factory tested

SPECIFICATION								
Seat Material	Temp. Range	Pressure	Leak Rates					
			Inboard	Across Seat				
PTFE	-10 ~ 80°C	10kgf/cm <sup>2</sup>	$\leq 1.0 \times 10^{-6}$ atm.cc/sec He	$\leq 1.0 \times 10^{-6}$ atm.cc/sec He				
FLANGED END (JIS 10K)								
Model	Size	L	L1	X1	X	H	D1	
15A	1/2"	162	109	56	161	38	21.7	
20A	3/4"	177	109	56	164	41.7	27.2	
25A	1"	193	131	66	178	44.4	34	
32A	1-1/4"	214	165	86	203	54	42.7	
40A	1-1/2"	277	165	86	228	59.5	48.6	
50A	2"	300	165	86	236	67	60.5	
65A	2-1/2"	356	200	104	283	101.5	76.3	
80A	3"	402	200	104	296	112.5	89.1	
100A	4"	483.6	249	120	310	127	114.3	

**STRUCTURE**

Parts	Material
BODY	SUS316
CAP	SUS316L
BALL	SUS316
BALL SEAT	PTFE
JOINT GASKET	PTFE
STEM	SUS316
THRUST WASHER	PTFE
STEM PACKING	PTFE
HIGH WASHER	SUS304
BELLEVILLE WASHER	SUS304
STEM NUT	SUS304
O-RING	VITON
BOLT	SUS304
SPRING WASHER	SUS304
HEX NUT	SUS304
STOPPER	SUS304
HANDLE	SUS304
PLASTIC COVER	PLASTIC
STOPPER PIN	SUS304
LOCK WASHER	SUS304

BUTT WELD END

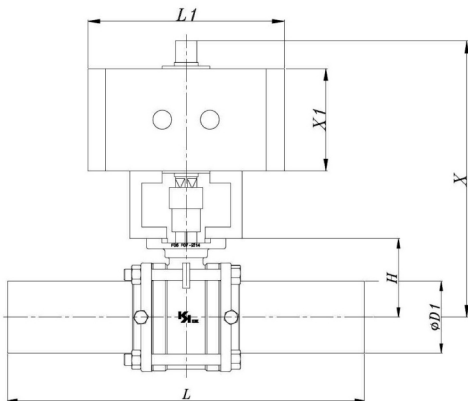

## # V3NMH SERIES

**3-PIECE FULL PORT BALL VALVE**

STAINLESS STEEL

SUS 316(EN10213-4 1.4408)(ASTM-A351-CF8M)

SUS 304(EN10213-4 1.4308)(ASTM-A351-CF8)

FEATURES:

Blow-out proof stem , lever operated

Investment casingy body and cap

Direct Mountig Pad for ISO Standard 5211

100% factory tested

BUTT WELD END

## FLANGED END

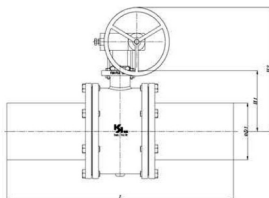

SPECIFICATION				
Seat Material	Temp. Range	Pressure	Leak Rates	
			Inboard	Across Seat
PTFE	-10 ~ 80°C	10kgf/cm <sup>2</sup>	≤ 1.0×10 <sup>-1</sup> atm.cc/sec He	≤ 1.0×10 <sup>-6</sup> atm.cc/sec He

**FLANGED END (JIS 10K)**

Model	Size	L	H	H1	H2	D1
125A	5"	583	158.5	47	335	139.8
150A	6"	692	175	47	355	165.2
200A	8"	880	210	47	400	216.3

**STRUCTURE**

Parts	Material
BODY	SUS 316
GAP	SUS 316L
BALL	SUS 316
BALL SEAT	PTFE
JOINT GASKET	PTFE
STEM	SUS 316
THRUST WASHER	PTFE
STEM PACKING	PTFE
HIGH WASHER	SUS 304
BELLEVILLE WASHER	SUS 304
STEM NUT	SUS 304
O-RING	VITON
BOLT	SUS 304
SPRING WASHER	SUS 304
HEX NUT	SUS 304
STOPPER	SUS 304
HANDLE	SUS 304
PLASTIC COVER	PLASTIC
STOPPER PIN	SUS 304
LOCK WASHER	SUS304

## BUTT WELD END+OPP(SWG)

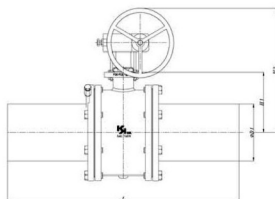

## BUTT WELD END+IOPP(SWG)

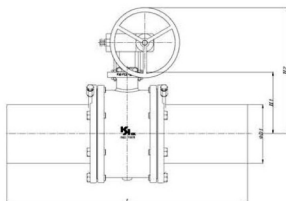

## # Purge port

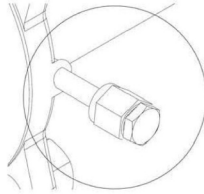
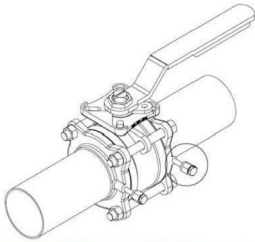

### Purge port 擴充示意圖

#### Purge port(OPP):SWG

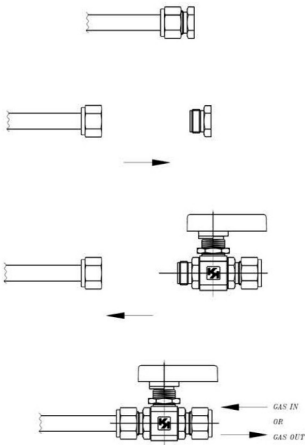

15A ~ 100A : 1/4" SWG  
125A ~ 250A : 1/2" SWG

#### Purge port(OPP):VCR

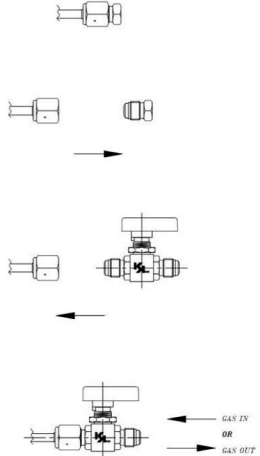

15A ~ 100A : 1/4" VCR  
125A ~ 250A : 1/2" VCR

## # V3NMH SERIES

## 3-PIECE FULL PORT BALL VALVE

STAINLESS STEEL

SUS 316(EN10213-4 1.4408)(ASTM-A351-CF8M)

SUS 304(EN10213-4 1.4308)(ASTM-A351-CF8)

FEATURES:

Blow-out proof stem /Full port

Investment casting body and cap

Direct Mounting Pad for ISO Standard 5211

BUTT WELD END

100% factory tested

SPECIFICATION				
Seat Material	Temp.Range	Pressure	Leak Rates	
			Inborad	Across Seat
PTFE	-10 ~ 80°C	10kgf/cm <sup>2</sup>	≤ 1.0×10 <sup>-6</sup> atm.cc/sec He	≤ 1.0×10 <sup>-6</sup> atm.cc/sec He

## FLANGED END (JIS 10K)

Model	Size	W	L	H	H1	D1
15A	1/2"	112	151	38	9.8	21.7
20A	3/4"	112	155	38	9.8	27.1
25A	1"	138	186.2	41.7	9.8	34
32A	1-1/4"	138	195.6	44.4	11.5	42.7
40A	1-1/2"	205	231.6	54	11.5	48.6
50A	2"	205	243.4	59.5	16	60.5
65A	2-1/2"	205	290.2	67	16	76.3
80A	3"	330	290.2	101.5	16	89.1
100A	4"	330	324.5	112.5	19	114.3
125A	5"	330	512	127	19	139.8
150A	6"	500	574	158.5	19	165.2
200A	8"	500	654	175	47	216.3
250A	10"	1000	880	210	47	267.4

## STRUCTURE

Parts	Material
BODY	SUS316
CAP	SUS316L
BALL	SUS316
BALL SEAT	PTFE
JOINT GASKET	PTFE
STEM	SUS316
THRUST WASHER	PTFE
STEM PACKING	PTFE
HIGH WASHER	SUS304
BELLEVILLE WASHER	SUS304
STEM NUT	SUS304
O-RING	VITON
BOLT	SUS304
SPRING WASHER	SUS304
HEX NUT	SUS304
STOPPER	SUS304
HANDLE	SUS304
PLASTIC COVER	PLASTIC
STOPPER PIN	SUS304
LOCK WASHER	SUS304

## BUTT WELD END

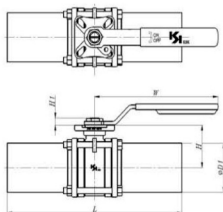

## BUTT WELD END+OPP(SWG)

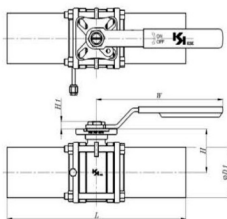

## BUTT WELD END+IOPP(SWG)

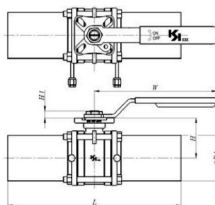

## # V3NMH SERIES

**3-PIECE FULL PORT BALL VALVE**

STAINLESS STEEL

SUS 316(EN10213-4 1.4408)(ASTM-A351-CF8M)

SUS 304(EN10213-4 1.4308)(ASTM-A351-CF8)

FEATURES:

Blow-out proof stem /Full port

Investment casting body and cap

Direct Mountig Pad for ISO Standard 5211

BUTT WELD END

100% factory tested

SPECIFICATION							
Seat Material	Temp.Range	Pressure	Leak Rates				
			Inborad	Across Seat			
PTFE	-10 ~ 80°C	10kgf/cm <sup>2</sup>	$\leq 1.0 \times 10^{-6}$ atm.cc/sec He		$\leq 1.0 \times 10^{-6}$ atm.cc/sec He		
BUTT WELD END							
Model	Size	L	L2	X1	X	H	D1
15A	1/2"	151	250	66	172	38	21.7
20A	3/4"	155	250	66	172	38	27.2
25A	1"	186.2	311	86	194	41.7	34
32A	1-1/4"	195.6	311	86	197	44.4	42.7
40A	1-1/2"	231.6	311	86	242	54	48.6
50A	2"	243.4	365	104	247	59.5	60.5
65A	2-1/2"	290.2	365	104	255	67	76.3
80A	3"	290.2	417	120	288	101.5	89.1
100A	4"	354.5	417	120	301	112.5	114.3
125A	5"	512	516	150	320	127	139.8

BUTT WELD END

**STRUCTURE**

Parts	Material
BODY	SUS316
CAP	SUS316L
BALL	SUS316
BALL SEAT	PTFE
JOINT GASKET	PTFE
STEM	SUS316
THRUST WASHER	PTFE
STEM PACKING	PTFE
HIGH WASHER	SUS304
BELLEVILLE WASHER	SUS304
STEM NUT	SUS304
O-RING	VITON
BOLT	SUS304
SPRING WASHER	SUS304
HEX NUT	SUS304
STOPPER	SUS304
HANDLE	SUS304
PLASTIC COVER	PLASTIC
STOPPER PIN	SUS304
LOCK WASHER	SUS304

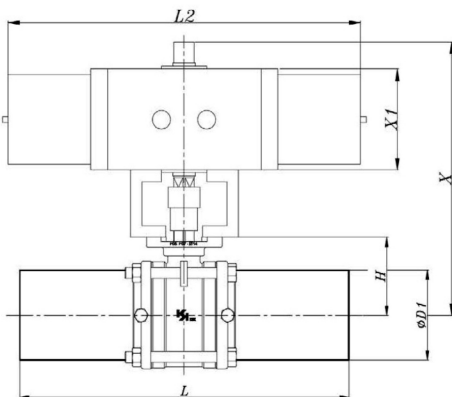

## # V3NMHR SERIES

**3-PIECE FULL PORT BALL VALVE**

STAINLESS STEEL

SUS 316(EN10213-4 1.4408)(ASTM-A351-CF8M)

SUS 304(EN10213-4 1.4308)(ASTM-A351-CF8)

FEATURES:

Blow-out proof stem /Full port

Investment casingy body and cap

Direct Mountig Pad for ISO Standard 5211

BUTT WELD END

100% factory tested

SPECIFICATION							
Seat Material	Temp.Range	Pressure	Leak Rates				
			Inborad	Across Seat			
PTFE	-10 ~ 80°C	10kgf/cm <sup>2</sup>	$\leq 1.0 \times 10^{-6}$ atm.cc/sec He	$\leq 1.0 \times 10^{-6}$ atm.cc/sec He			
BUTT WELD.END							
Model	Size	L	L1	X1	X	H	D1
15A	1/2"	151	109	56	161	38	21.7
20A	3/4"	155	109	56	161	38	27.2
25A	1"	186.2	109	56	164	41.7	34
32A	1-1/4"	195.6	131	66	178	44.4	42.7
40A	1-1/2"	231.6	165	86	203	54	48.6
50A	2"	243.4	165	86	228	59.5	60.5
65A	2-1/2"	290.2	165	86	236	67	76.3
80A	3"	290.2	200	104	283	101.5	89.1
100A	4"	354.5	200	104	296	112.5	114.3
125A	5"	483.6	249	120	310	127	139.8

BUTT WELD END

**STRUCTURE**

Parts	Material
BODY	SUS316
CAP	SUS316L
BALL	SUS316
BALL SEAT	PTFE
JOINT GASKET	PTFE
STEM	SUS316
THRUST WASHER	PTFE
STEM PACKING	PTFE
HIGH WASHER	SUS304
BELLEVILLE WASHER	SUS304
STEM NUT	SUS304
O-RING	VITON
BOLT	SUS304
SPRING WASHER	SUS304
HEX NUT	SUS304
STOPPER	SUS304
HANDLE	SUS304
PLASTIC COVER	PLASTIC
STOPPER PIN	SUS304
LOCK WASHER	SUS304

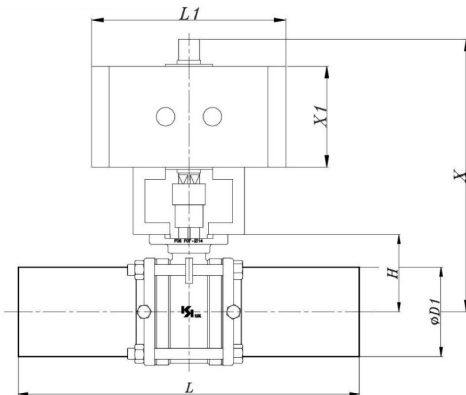

## # V3NMHR SERIES

## 3-PIECE FULL PORT BALL VALVE

STAINLESS STEEL

SUS 316(EN10213-4 1.4408)(ASTM-A351-CF8M)

SUS 304(EN10213-4 1.4308)(ASTM-A351-CF8)

FEATURES:

Blow-out proof stem /Full port

Investment casingy body and cap

Direct Mountig Pad for ISO Standard 5211

BUTT WELD END

100% factory tested



SPECIFICATION						
Seat Material	Temp. Range	Pressure	Leak Rates		H1	H2
			Inboard	Across Seat		
PTFE	-10 ~ 80°C	10kgf/cm <sup>2</sup>	$\leq 1.0 \times 10^{-6}$ atm.cc/sec He	$\leq 1.0 \times 10^{-6}$ atm.cc/sec He		
BUTT WELD END						
Model	Size	L	H	H1	H2	D1
150A	6"	574	158.5	47	335	165.2
200A	8"	654	175	47	355	216.3
250A	10"	880	210	47	400	267.4

STRUCTURE	
Parts	Material
BODY	SUS316
CAP	SUS316L
BALL	SUS316
BALL SEAT	PTFE
JOINT GASKET	PTFE
STEM	SUS316
THRUST WASHER	PTFE
STEM PACKING	PTFE
HIGH WASHER	SUS304
BELLEVILLE WASHER	SUS304
STEM NUT	SUS304
O-RING	VITON
BOLT	SUS304
SPRING WASHER	SUS304
HEX NUT	SUS304
STOPPER	SUS304
HANDLE	SUS304
PLASTIC COVER	PLASTIC
STOPPER PIN	SUS304
LOCK WASHER	SUS304

BUTT WELD END

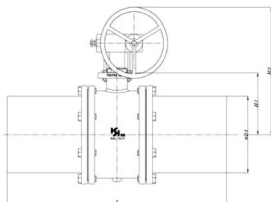

BUTT WELD END+OPP(SWG)

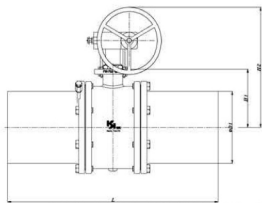

BUTT WELD END+IOPP(SWG)

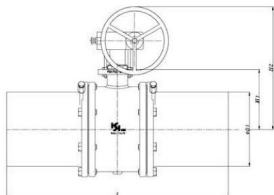



## # BS SERIES

## 3-PIECE FULL PORT BALL VALVE

STAINLESS STEEL

SUS 316(EN10213-4 1.4408)(ASTM-A351-CF8M)

SUS 304(EN10213-4 1.4308)(ASTM-A351-CF8)

FEATURES:

Body and cap materials available in 316 stainless steel

The platform is fixed

SWG. END , MALE VCR END , BUTT WELD END

100% factory tested



SPECIFICATION						
Seat Material	Temp. Range	Pressure	Leak Rates		W	F
			Inboard	Across Seat		
PTFE	-10 ~ 80°C	10kqf/cm <sup>2</sup>	$\leq 1.0 \times 10^{-5}$	$\leq 1.0 \times 10^{-5}$		
TFM1600	-10 ~ 120°C	165kqf/cm <sup>2</sup>	atm.cc/sec.He	atm.cc/sec.He		
SWG. END						
Model	Size	d	L	H	W	F
1BS-SW-SS	1/16"	1.58	50.3	38.7	45.5	15
2BS-SW-SS	1/8"	3.175	58.9	38.7	45.5	15
4BS-SW-SS	1/4"	6.35	64	38.7	45.5	15
6BS-SW-SS	3/8"	9.52	74	42	59.3	18
8BS-SW-SS	1/2"	12.7	82	47	67	20
12BS-SW-SS	3/4"	19.05	89	49.75	67	23
BUTT WELD END						
Model	Size	d	L	H	W	F
4BS-BW-SS	1/4"	6.35	87	38.7	45.5	15
6BS-BW-SS	3/8"	9.52	91	42	59.3	18
8BS-BW-SS	1/2"	12.7	96.5	47	67	20
12BS-BW-SS	3/4"	19.05	114	49.75	67	23
MALE VCR END						
Model	Size	d	L	H	W	F
4BS-MV-SS	1/4"	4.35	60.6	38.7	45.5	15
8BS-MV-SS	1/2"	10.22	72.1	47	67	20
12BS-MV-SS	3/4"	15.75	93	49.75	67	23
STRUCTURE						
Parts	Material					
BODY	SUS316					
CAP	SUS316					
BALL	SUS316					
BALL SEAT	PTFE					
HANDLE	POM					
PANEL NUT	SUS316					

SWG . END

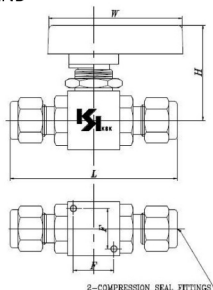

SWG . END

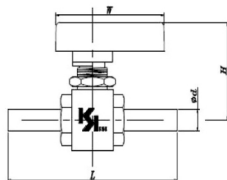

SWG . END

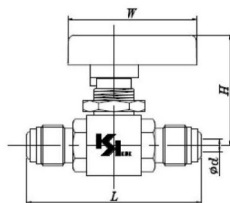

## # BSA SERIES

## 3-PIECE FULL PORT BALL VALVE

STAINLESS STEEL

SUS 316(EN10213-4 1.4408)(ASTM-A351-CF8M)

SUS 304(EN10213-4 1.4308)(ASTM-A351-CF8)

FEATURES:

Body and cap materials available in 316 stainless steel

The platform is fixed

SWG. END , MALE VCR END

100% factory tested



SPECIFICATION						
Seat Material	Temp.Range	Pressure	Leak Rates		H	W
			Inboard	Across Seat		
PTFE	-10 ~ 80°C	10kgf/cm <sup>2</sup>	≤ 1.0×10 <sup>-5</sup>	≤ 1.0×10 <sup>-5</sup>		
TFM1600	-10 ~ 120°C	165kgf/cm <sup>2</sup>	atm.cc/sec He	atm.cc/sec He		
SWG. END						
Model	Size	d	L	L2	H	W
1BSA-SW-SS	1/16"	1.58	25.15	14.5	38.7	45.5
2BSA-SW-SS	1/8"	3.175	29.45	14.5	38.7	45.5
4BSA-SW-SS	1/4"	6.35	32	14.5	38.7	45.5
6BSA-SW-SS	3/8"	9.52	37	17.5	42	59.3
8BSA-SW-SS	1/2"	12.7	41	18.25	47	67
12BSA-SW-SS	3/4"	19.05	44.5	21	49.75	67
MALE VCR END						
Model	Size	d	L	L2	H	W
4BSA-MV-SS	1/4"	6.35	87	38.7	45.5	15
6BSA-MV-SS	3/8"	9.52	91	42	59.3	18
8BSA-MV-SS	1/2"	12.7	96.5	47	67	20
12BSA-MV-SS	3/4"	19.05	114	49.75	67	23
STRUCTURE						
Parts	Material					
BODY	SUS316					
CAP	SUS316					
BALL	SUS316					
BALL SEAT	PTFE					
STEM	SUS316					
HANDLE	POM					
PANEL NUT	SUS316					

SWG . END

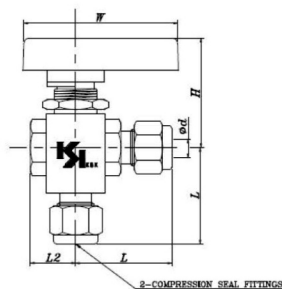

MALE VER END

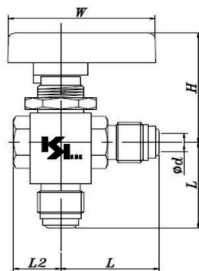

## # BST SERIES

### 3-PIECE FULL PORT BALL VALVE

STAINLESS STEEL

SUS 316(EN10213-4 1.4408)(ASTM-A351-CF8M)

SUS 304(EN10213-4 1.4308)(ASTM-A351-CF8)

FEATURES:

Body and cap materials available in 316 stainless steel

The platform is fixed

SWG. END , MALE VCR END

100% factory tested



SPECIFICATION					
Seat Material	Temp.Range	Pressure	Leak Rates		
			Inboard	Across Seat	
PTFE	-10 ~ 80°C	10kgf/cm <sup>2</sup>	≤ 1.0×10 <sup>-6</sup>	≤ 1.0×10 <sup>-6</sup>	
TFM1600	-10 ~ 120°C	165kgf/cm <sup>2</sup>	atm.cc/sec.He	atm.cc/sec.He	
SWG. END					
Model	Size	d	L	H	W
1BST-SW-SS	1/16"	1.58	25.15	38.7	45.5
2BST-SW-SS	1/8"	3.175	29.45	38.7	45.5
4BST-SW-SS	1/4"	6.35	32	38.7	45.5
6BST-SW-SS	3/8"	9.52	37	42	59.3
8BST-SW-SS	1/2"	12.7	41	47	67
12BST-SW-SS	3/4"	19.05	44.5	49.75	67
MALE VCR END					
Model	Size	d	L	H	W
4BST-MV-SS	1/4"	4.35	30.3	38.7	45.5
8BST-MV-SS	1/2"	10.22	36.05	47	67
12BST-MV-SS	3/4"	15.75	46.5	49.75	67
STRUCTURE					
Parts	Material				
BODY	SUS316				
CAP	SUS316				
BALL	SUS316				
BALL SEAT	PTFE				
STEM	SUS316				
HANDLE	POM				
PANEL NUT	SUS316				

SWG . END

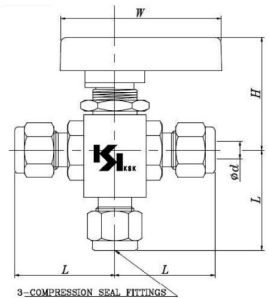

MALE VER END

